

SHARP

User Guide

MS1

(Model : FS8001)

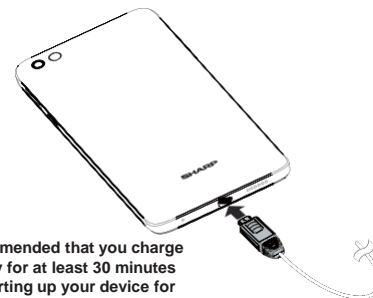
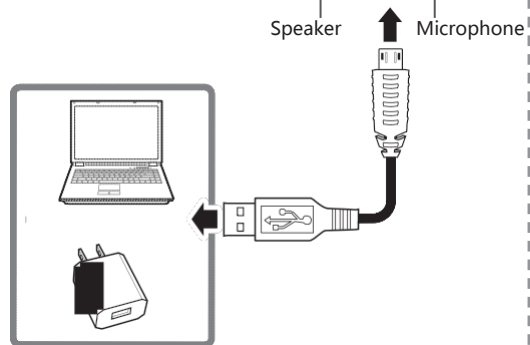
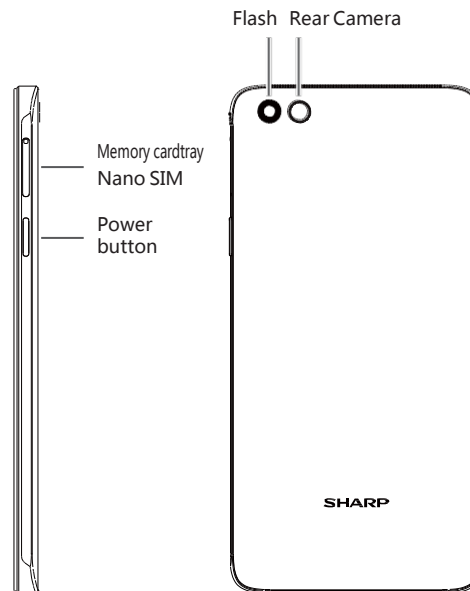
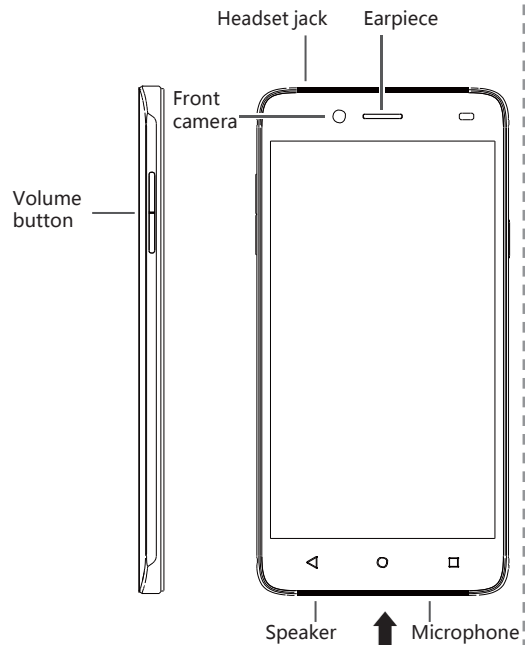

※It is recommended that you charge the battery for at least 30 minutes before starting up your device for the first time.

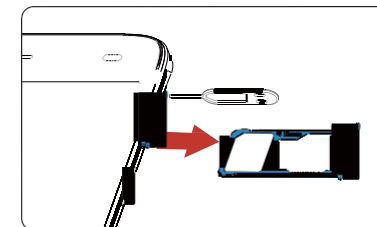

Nano SIM 1 / Nano SIM 2

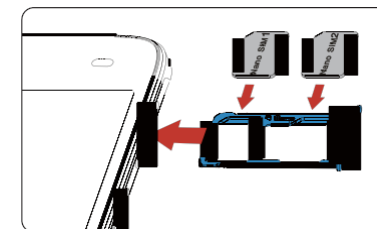

Nano SIM / Micro SD

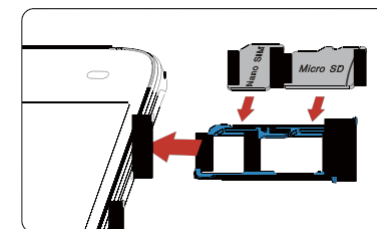

Important Safety Information

Please read before proceeding

- DO NOT place sharp objects on top of the device, as they may scratch the screen.
- DO NOT drop your device or subject it to severe impacts.
Bending the body and pushing the display or keys with extreme force could damage the device.
- DO NOT use a pen or any sharp object to tap the screen.
- DO NOT expose the device to dirty or dusty environments.
- DO NOT place the device on an uneven or unstable surface.
- DO NOT insert any foreign objects into the device.
- DO NOT expose the device to strong magnetic or electrical field.
- DO NOT use or store this equipment in a place where it will be exposed to high temperatures, such as near an open flame or heat-emitting equipment.
- DO NOT use it or store it where fluids such as water can splash onto it.
Raindrops, water spray, juice, coffee, steam, or other types of liquids will also cause malfunctions.
- Refer to the rating label on the device and be sure that the power adapter complies with the rating. Only use accessories provided by the manufacturer.
- Disconnect the device from an electrical outlet and power off before cleaning the device.
- NEVER attempt to connect or disconnect the power adapter with wet hands.
- Clean the touch screen with a soft cloth. If needed, dampen the cloth slightly before cleaning. Never use abrasives or cleaning solutions.
- DO NOT disassemble the device. Only a certified service technician should perform repair.
- Please check with your Local Authority or retailer for proper disposal of electronic products.
- For USB connection, users must use a USB 2.0 (or higher version) cable.
- The adapter shall be installed near the equipment and shall be easily accessible.
- The temperature of the device might increase while the CPU is busy handling resource consuming activities such as high resolution video decoding. The SW protection mechanism will ensure stop charging whenever the temperature is over the predefined threshold and prepare for shut down if necessary.
Please worry not.
- Use a wireless hands-free system (headphone, headset) with a low power Bluetooth emitter.
- Make sure the cell phone has a low SAR.
- Keep your calls short or send a text message (SMS) instead.
This advice applies especially to children, adolescents and pregnant women.
- Use cell-phone when the signal quality is good.
- People having active medical implants should preferably keep the cell phone at least 15 cm away from the implant.

Safety Precautions for Battery Use

- The phone battery can not be removed, please do not disassemble.
- There is the danger of explosion if disassemble by unauthorized personnel.
- Recycle or dispose used batteries according to the local regulations.



Road and Environmental Safety

- Turn off the phone in areas with a potentially explosive atmosphere or where flammable objects exist such as gas stations, fuel depots, and chemical plants among others. Sparks from these areas could cause explosion or fire and result in injury or even death.
- Do not use hand-held phones while driving a vehicle. Use hands-free devices as an alternative.

Safety in Aircraft

Do not use the phone on board an aircraft. The phone's network signals may cause interference to the navigation system. As a safety measurement, it is prohibited to use mobile phones on board in most countries.

Copyright Information

- Copyright© SHARP Corporation, 2012. All rights reserved.
- This product has an Android™ platform based on Linux, which can be expanded by a variety of JME-based application SW.
- Android, Google, Google Play, the Google Play logo and other marks are trademarks of Google Inc.
- microSD™ is a trademark of SD Card Association.
- All products use in this device and trademarks mentioned herein are trademarks or registered trademarks of their respective owners.
- LTE is a trade mark of ETSI

Intellectual Property Right Information

Right to all technologies and products that comprise this device are the property of their original owners respectively.

This product has an Android™ platform based on Linux, which can be expanded by a variety of Java-Script-based application SW.

Compliance Information

SAR Information

THIS MOBILE DEVICE MEETS GUIDELINES FOR EXPOSURE TO RADIO WAVES. Your mobile device is a radio transmitter and receiver. It is designed not to exceed the limits for exposure to radio waves recommended by international guidelines. These guidelines were developed by the independent scientific organization ICNIRP and include safety margins designed to assure the protection of all persons, regardless of age and health. The exposure guidelines for mobile devices employ a unit of measurement known as the Specific Absorption Rate or SAR. The SAR limit stated in the ICNIRP guidelines is 2.0 W/kg averaged over 10 grams of tissue. Tests for SAR are conducted using standard operating positions with the device transmitting at its highest certified power level in all tested frequency bands. The actual SAR level of an operating device can be below the maximum value because the device is designed to use only the power required to reach the network. That amount changes depending on a number of factors such as how close you are to a network base station. The highest SAR value under the ICNIRP guidelines for use of the device at the ear is 0.485 W/kg (the measure distance of 0 mm) and at the body is 1.440 W/kg (the measure distance of 5 mm). Use of device accessories and enhancements may result in different SAR values. SAR values may vary depending on national reporting and testing requirements and the network band.

WEEE Notice

The WEEE logo on the product or on its box indicates that this product must not be disposed of or dumped with your other household waste. You are liable to dispose of all your electronic or electrical waste equipment by relocating over to the specified collection point for recycling of such hazardous waste. Isolated collection and proper recovery of your electronic and electrical waste equipment at the time of disposal will allow us to help conserve natural resources. Moreover, proper recycling of the electronic and electrical waste equipment will ensure

safety of human health and environment. For more information about electronic and electrical waste equipment disposal, recovery, and collection points, please contact your local city center, household waste disposal service, shop from where you purchased the equipment, or manufacturer of the equipment.

RoHS Compliance

This product is in compliance with DIRECTIVE 2011/65/EU OF THE EUROPEAN PARLIAMENT AND OF THE COUNCIL of 8 June 2011, on the restriction of the use of certain hazardous substances in electrical and electronic equipment and its amendments.

Warranty Statement

Limited warranty

SHARP provides "Product Warranty Statement", at the time of its original purchase, from the SHARP or its authorized distributor, describing the product warranty service. Notes: SHARP does not provide global cross border warranty. This limited warranty (free of defects in materials and workmanship causing malfunction and defective) shall last for twelve (12) months for the device, including the battery in non-removable type; and six (6) months for the battery in removable type from the purchase date. Other than battery, the in-box Accessories(if available), limited to cables, earphone and power transformer, six (6) months warranty period is provided. The customer shall present the PROOF OF PURCHASE upon claiming the warranty.

Throughout the warranty period SHARP or its authorized agent will, at own discretion and subject to section Non-Warranty below repair or replace a defective product. All replaced defective parts or components will become the property of SHARP after returning the repaired/replaced product in good working condition. This repair on the same symptom beyond the warranty period or caused by misuse, three(3) months warranty period is provided.

European Union Regulatory Conformance

The equipment complies with the RF Exposure Requirement 1999/519/EC, Council Recommendation of 12 July 1999 on the limitation of exposure of the general public to electromagnetic fields (0–300 GHz). This equipment meets the following conformance standards: EN50360, EN62209-1/-2, EN62311, EN62479, EN50566, EN60950-1, EN50332-2, EN301489-1/-3/-7/-17/-24, EN55022, EN55024, EN61000-3-2/-3-3, EN301511, EN301511, EN301511-1/-2/-13, EN300328, EN300440-1/-2, EN50581.

This device have been tested to comply with the Sound Pressure Level requirement laid down in the applicable EN 50332-1 and/or EN 50332-2 standards. Permanent hearing loss may occur if earphones or headphones are used at high volume for prolonged periods of time.

Prevention of Hearing Loss

Warning statement requirement under EN 60950-1:A2.



To prevent hearing damage, do not listen at high volume levels for long periods.

Note: For France, headphones/earphones for this device are compliant with the sound pressure level requirement laid down in the applicable EN50332-1:2013 and/or EN50332-2:2013 standard as required by French Article L.5232-1.



A pleine puissance, l'écoute prolongée du baladeur peut endommager l'oreille de l'utilisateur.

The conformity assessment procedure has been followed with the involvement of the following Notified Body:

Cetecom TESTLAB
Identification mark: CE0682
(Notified Body) CE

CE 0682

Changes or modifications to this product not authorized by the manufacturer could void the EMC compliance and negate your authority to operate the product. This product has demonstrated EMC compliance under conditions that included the use of compliant peripheral devices and shielded cables between system components. It is important that you use compliant peripheral devices and shielded cables between system components to reduce the possibility of causing interference to radios, televisions, and other electronic devices.

We, hereby, declare that this Smartphone is in compliance with the essential requirements and other relevant provisions of Directive 1999/5/EC.

We, hereby, declare that this Smartphone is in compliance with the essential requirements and other relevant provisions of Directive 1999/5/EC.

Non-Warranty

No warranty may be asserted or claimed if (1) the product serial number, date code, IMEI, water indicator or the warranty seal has been removed, erased, defaced or altered; or (2) the defect is found to be caused by:

- (1) By engineering judgement, the product is mishandled/misused carelessly or accidentally. Unauthorized disassembling or repair, repair by use if unauthorized spare parts, or other actions beyond the reasonable control of SHARP.
- (2) Improper shipping and packing.
- (3) Forces of nature of willful misconduct.
- (4) Rough handling, exposure to moisture, dampness or extreme thermal or environmental conditions or a rapid change in such conditions, corrosion, oxidation, unauthorized modifications or connections.
- (5) Deterioration of the product due to normal wear and tear.

Products installed or integrated with software or applications which are not made or authorized by SHARP.

Be sure to back up data and remove any confidential, proprietary or personal information from the product when asking service. SHARP is not responsible for the damage to or loss of any programs, data, or removable storage media inside or sent with the products. As to Non-warranty product, SHARP will check if a repair is economical/ available and provide a chargeable service to customer's consideration.

IN NO EVENT SHALL SHARP BE LIABLE UNDER THIS LIMITED WARRANTY FOR LOSS OF PROFIT, LOSS OF ANTICIPATED SAVINGS, LOSS OF DATA OR INDIRECT LOSS, LOSS OF THE PRODUCT OR ANY ASSOCIATED EQUIPMENT, INCIDENTAL OR CONSEQUENTIAL LOSSES OR DAMAGES OF ANY NATURE WHATSOEVER TO THE FULLEST EXTENT THAT THOSE LOSSES OR DAMAGES CAN BE DISCLAIMED BY LAW